



Chroma-Q™ Color Force™ 72 RGBA LED Fixture

**Part No:
CHCF72NFRGBA**

S P E C I F I C A T I O N S H E E T

V 1.0

DESCRIPTION

The fixture shall provide a very powerful 12,000 hot lumens output for washing areas up to 8m / 26ft high.
The fixture shall be suitable for creating a wide range of cyclorama flood, border, wall wash, effects and feature lighting applications in the entertainment and architectural sectors.
The fixture shall provide RGBA colour mixing.
The fixture shall provide a high CRI of 92.
The fixture shall provide a smooth, linear dimming curve.
The fixture shall offer a choice of HSI, Fx HSI, RGB, RGBA, RGB (*Magic Amber™) and sRGBI (*Magic Amber™) control modes.
The fixture shall feature a built-in stand-alone mode with real-time triggering.
The fixture shall feature a built-in power supply.
The fixture shall be manufactured from extruded material.

FEATURES

- Create a wide range of cyclorama flood, border, wall wash, effects and feature lighting applications in the entertainment and architectural sectors.
- 12,000 hot lumens output easily washes 8m / 26 foot.
- Extremely smooth, uniform wash.
- RGBA colour mixing.
- Radically increased colour palette.
- High CRI of 92.
- Theatrical grade dimming.
- Rugged extruded aluminium body.
- Built-in power supply.
- Hidden fixing and cable management for seamless wall washing and fast deployment.
- Perfect for theatre, TV, concert touring, exhibitions and corporate events.
- Optional 'Cyc' and 'Border' lens media accessories available.

OVERALL SPECIFICATIONS

Net dimensions:	Width: 1,760mm / 69" Height: 180mm / 7" Depth: 215mm / 8.5"
Net weight:	22kg / 48lb
Shipping dimensions:	Width: 1,855mm / 73" Height: 305mm / 12" Depth: 320mm / 12.5"
Shipping weight:	25kg / 56lb
Power input rating:	100-240V AC, 50-60Hz, 720W
Power connector in/out:	PowerCon
Data connectors in/out:	XLR 5-pin
Control protocol:	ANSI E1.1 DMX-512A
Cooling system:	Forced - 2x fans
Construction:	Anodised aluminium extrusion
Colour:	Black
LED cells:	12
LEDs per cell cells:	24 (6 x RGBA)

OVERALL SPECIFICATIONS cont.

Total LEDs:	288
Control modes:	43 channels Fx HSI 36 channels HSI 36 channels RGB (*Magic Amber) 48 channels RGBA 49 channels sRGBI (Magic Amber) 9 channels Fx HSI 3 channels HSI 3 channels RGB 4 channels RGBA 5 channels sRGBI (Magic Amber) 1 channel DMX Look Select
Dimming curve:	Theatrical
Variable effects engine:	Yes
Effects parameters:	Grouping, colour speed, colour fan, colour range, colour step, intensity effects and intensity fan
Hot lumen output:	White 12,000 hot lumen (prelim)
CRI:	92
Optics:	Specialised close focus lens
Beam angle:	12° (prelim)
Beam angle with optional Cyc lens:	60 x 10° (prelim)
Beam angle with optional Border lens:	50° (prelim)
Beam dispersion:	Symmetrical direct illumination
CCT:	Adjustable 1,000 – 10,000K
Lamp life:	L70 up to 50,000 hours
IP rating:	IP20
Built-in hardware:	Quick release lever for tilt adjustment
Approvals:	Pending for EN55103-1 & 2, IEC60950

ORDERING INFORMATION

Model	Part No
Chroma-Q Color Force 72 RGBA body finished in black	CHCF72NFRGBA
Chroma-Q Color Force 72 c/w Border lens, RGBA body finished in black	CHCF72BDRRGBA
Chroma-Q Color Force 72 c/w Cyc lens, RGBA body finished in black	CHCF72CYCRGBA

ACCESSORIES

Model	Part No
Chroma-Q Border lens for Color Force 72	CHCFBL72
Chroma-Q Cyc lens for Color Force 72	CHCFCL72

* Magic Amber is the term used for the unit's ability to bring in amber when mixing colours that require it.

www.chroma-q.com

All Chroma-Q LED products are licensed by Color Kinetics. Chroma-Q and all associated product names are recognised trademarks, for more information visit www.chroma-q.com/trademarks. The rights and ownership of all trademarks are recognised. The information contained herein is correct at the time of printing, however as we are constantly refining our product range we reserve the right to change the specification without notice. E60E.





**Chroma-Q™ Color Force™ 72
RGBA LED Fixture**

**Part No:
CHCF72NFRGBA**

S P E C I F I C A T I O N S H E E T

V 0.7

Dimensions

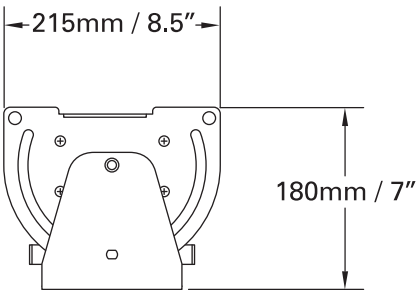
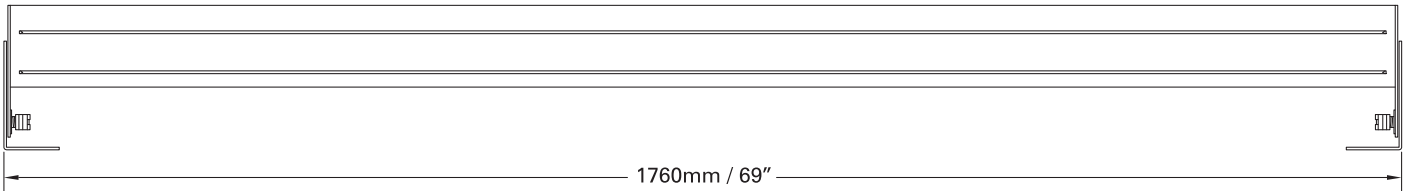
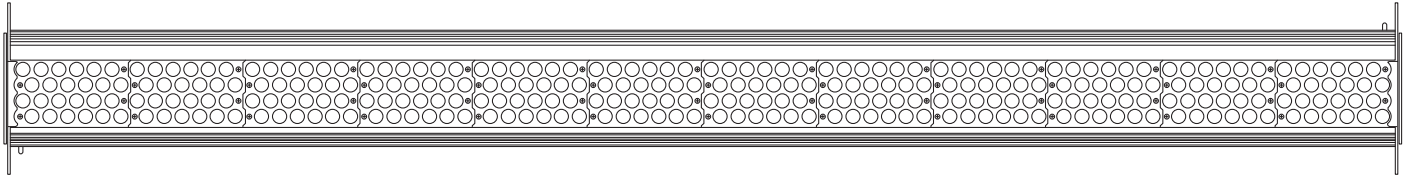

* Magic Amber is the term used for the unit's ability to bring in amber when mixing colours that require it.

www.chroma-q.com

All Chroma-Q LED products are licensed by Color Kinetics. Chroma-Q and all associated product names are recognised trademarks, for more information visit www.chroma-q.com/trademarks. The rights and ownership of all trademarks are recognised. The information contained herein is correct at the time of printing, however as we are constantly refining our product range we reserve the right to change the specification without notice. E60E.

