

12 11 10 9 8 7 6 5 4 3 2 1

H
G
F
E
D
C
B
A

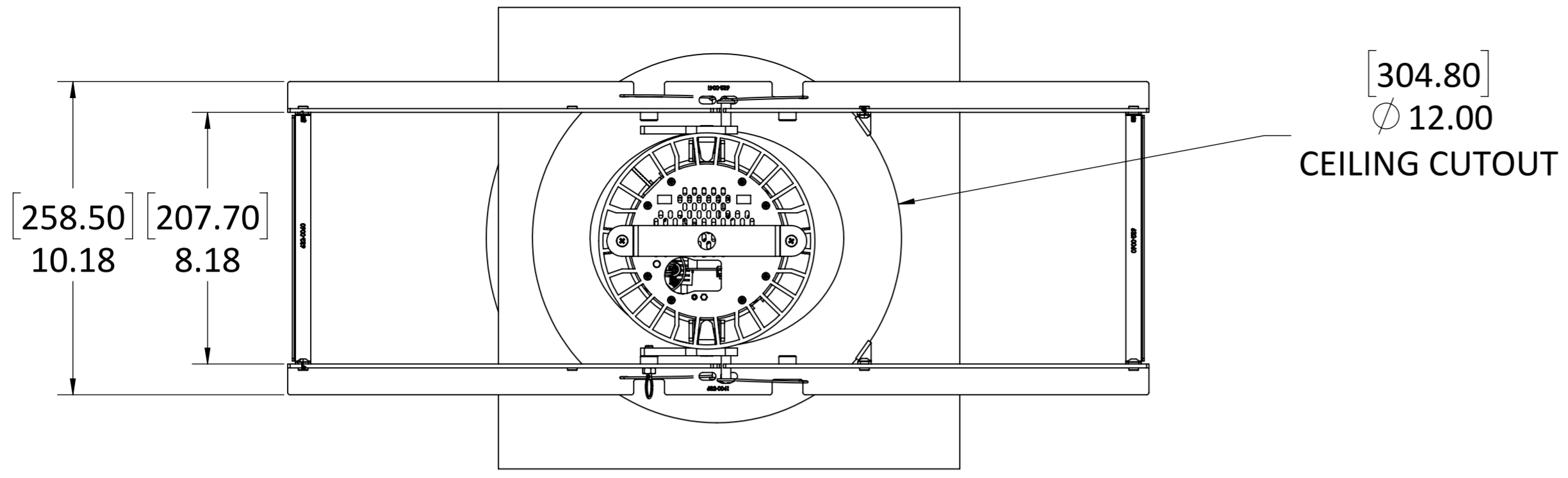

REVISIONS			
REV.	DESCRIPTION	DATE	APPROVED
A	INITIAL RELEASE	2018-04-13	JG
B	OVERALL DIMENSION TABLE IS ADDED	2020-03-17	PP

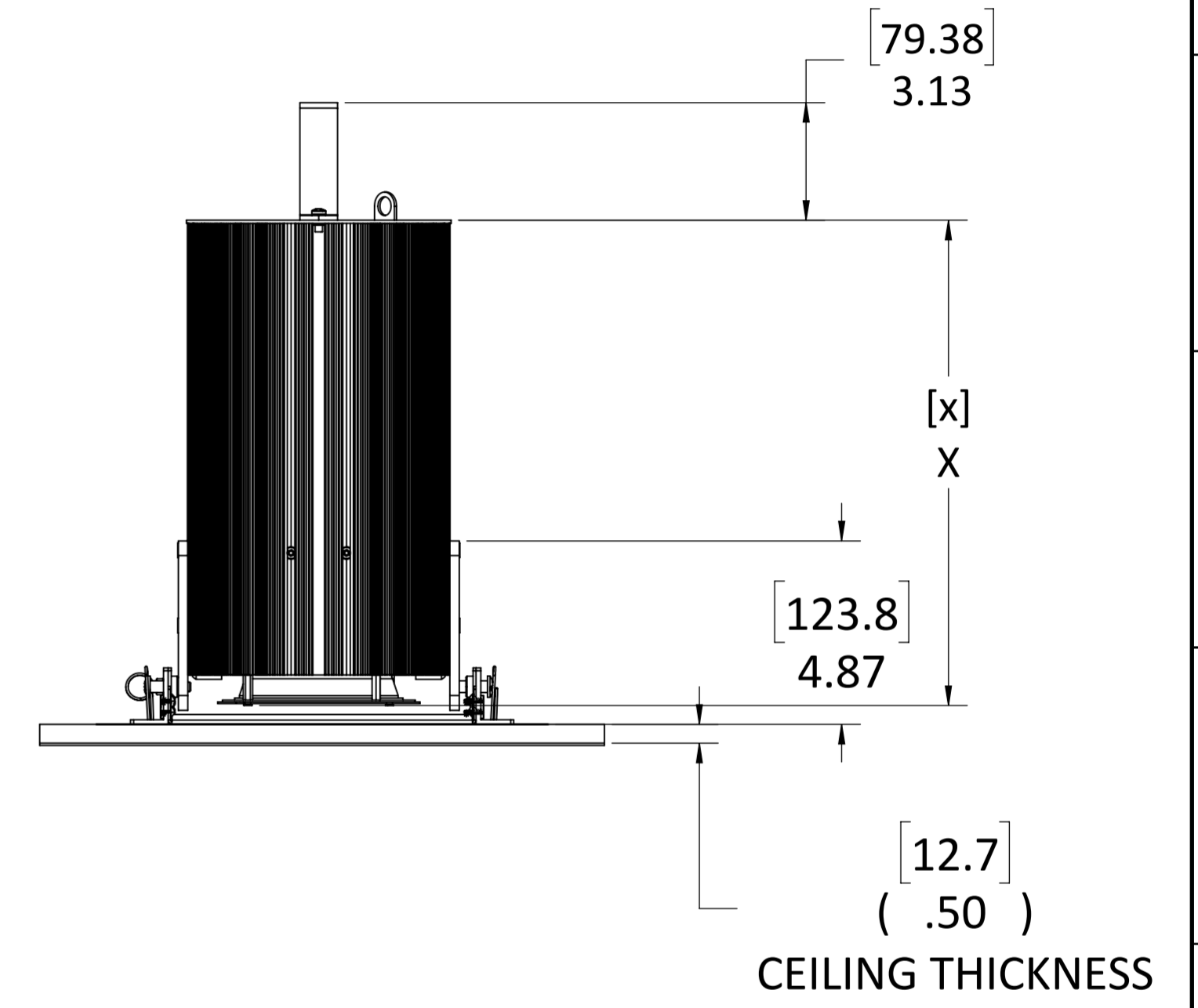
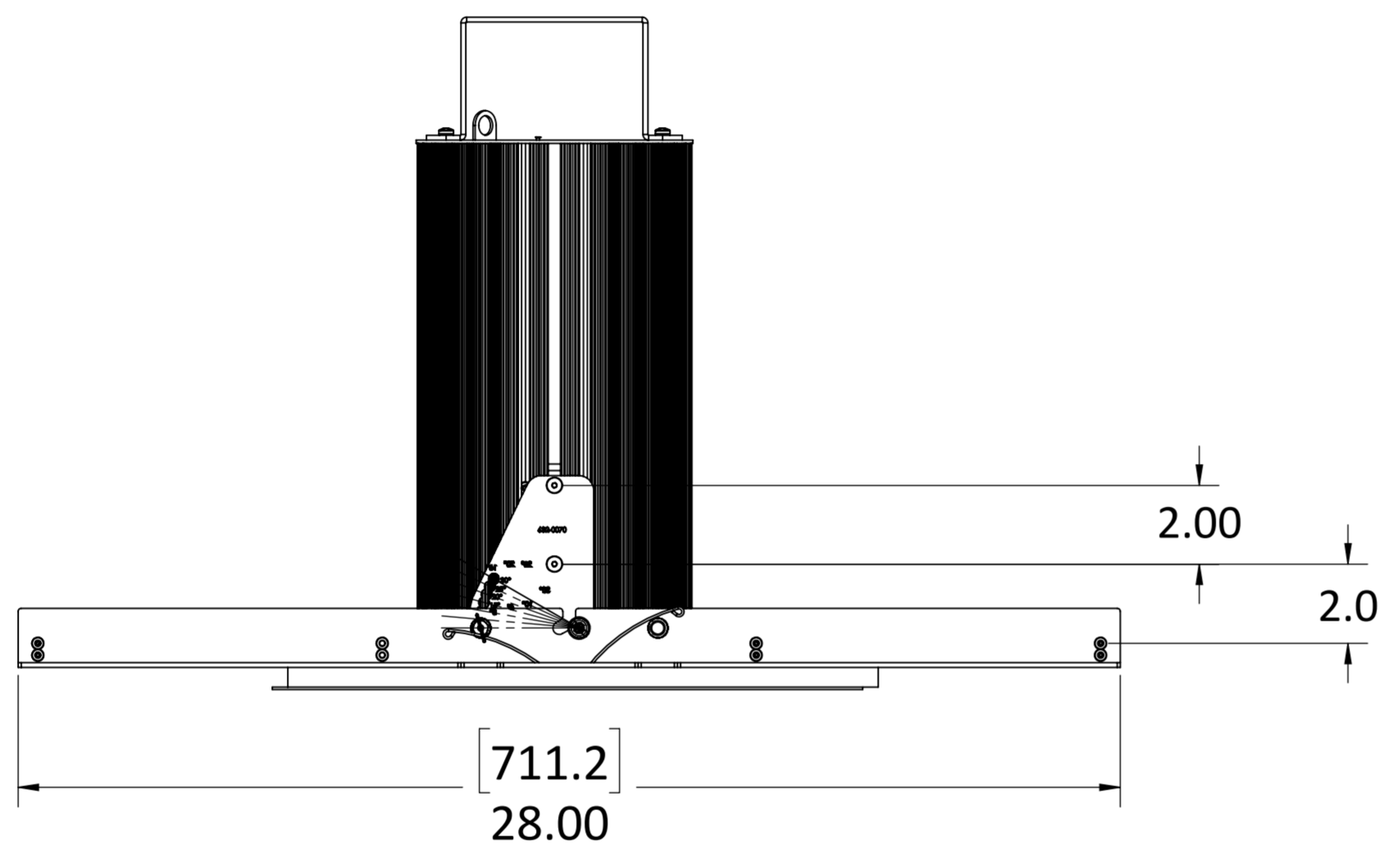

OVERALL DIMENSION TABLE		
INSPIRE	X (IN)	[x] (mm)
MINI	6.8	172.7
REGULAR	12.8	325.1
MD	12.8	325.1
XT	18.8	477.9

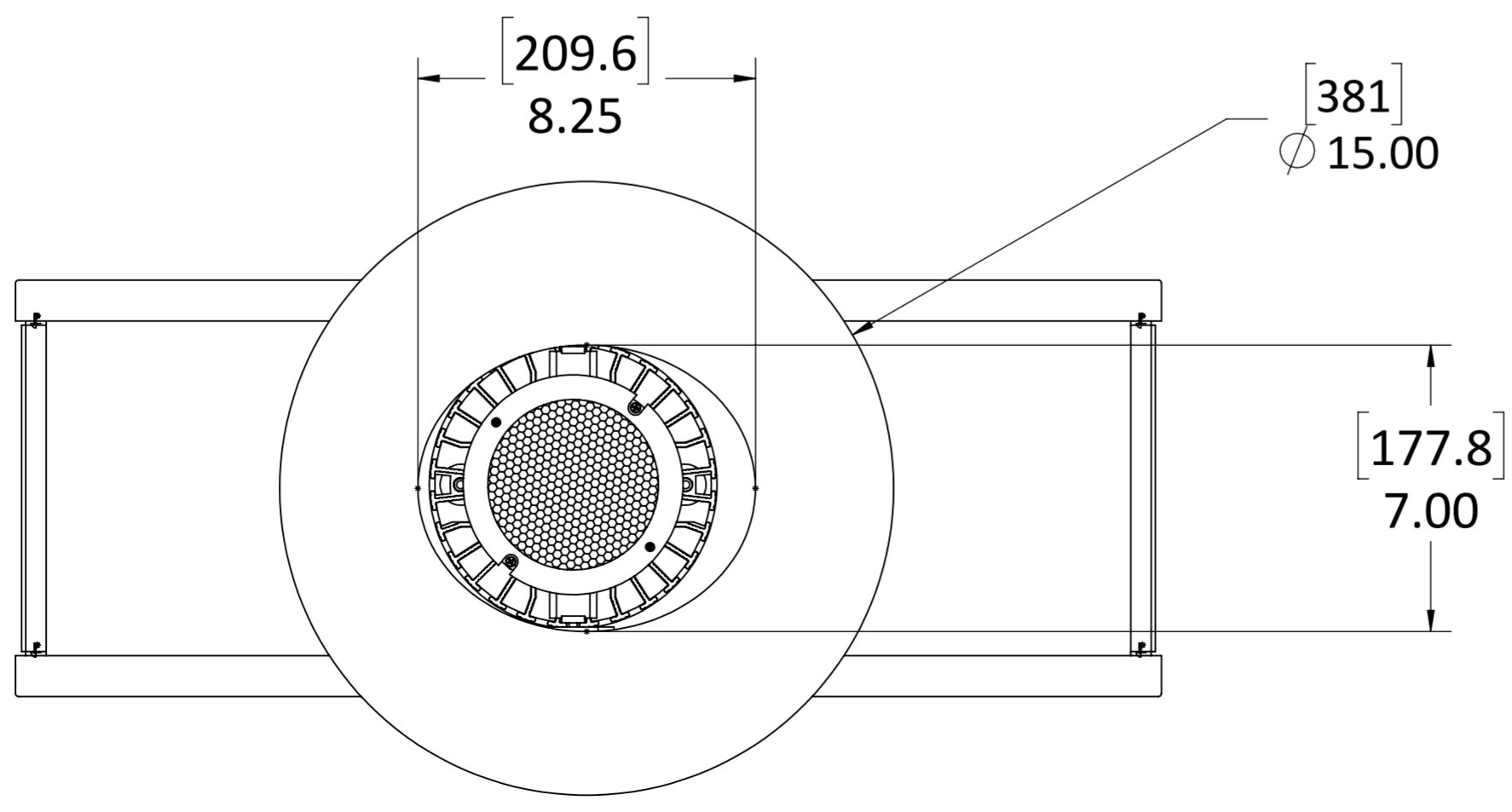

NOTE: SAME OVERALL DIMENSIONS ARE APPLICABLE FOR CHINSIK30W (MODEL:632-9306)

UNLESS OTHERWISE SPECIFIED:	NAME	DATE
DIMENSIONS ARE IN INCHES	DRAWN MB	2020-03-17
TOLERANCES:	CHECKED PP	2020-03-17
TWO PLACE DECIMAL ±0.01	ENG APPR.	
THREE PLACE DECIMAL ±0.003	MFG APPR.	
INTERPRET GEOMETRIC TOLERANCING PER:	Q.A.	
MATERIAL N/A	COMMENTS:	
FINISH N/A		
DO NOT SCALE DRAWING		



TITLE: **KIT BLIND SLANT CEILING 20 TO 30 DEGREE ANGLE BLACK AC P/N CHINSIK30B**

SIZE A2	DWG. NO. 632-9305	REV B
SCALE: 1:4	WEIGHT: 3.35 LBS / 1.51 KGS	SHEET 1 OF 1

12 11 10 9 8 7 6 5 4 3 2 1